

Part number

CHPT 10.4



Brief description:

surface mounting housings with 2 levers, size "57.27", 1/2" NPT, metal version, IP66



Product description

Version	metal version
Series	surface mounting housings with 2 levers
Product type	with 2 levers
Family	CLASS enclosures
Size	size "57.27"

Technical data

Material	metal
IP degree of protection	IP66 (and IP69K DIN 40050 - 9)
Cable entry	1/2" NPT

Further technical details

Weight	320,00 g
--------	----------

Approvals / Standards

Quality mark	UL (type:4/4X/12),  , EAC
Conformity	CQC, CE

General ordering information

EAN13 code	8015747023542
Tariff number	85369095

Packaging Information

Packaging length	475,00 mm
Packaging height	170,00 mm
Packaging width	150,00 mm
Packaging weight	6,40 kg
Packaging volume	12,11 dm ³
Packaging description	Carton box
Packaging quantity	10 Pcs
Packaging EAN code	8015747248952
Sub-packaging weight	3,20 kg
Sub-packaging description	Carton Box
Sub-packaging quantity	5 Pcs
Sub-packaging EAN barcode	8015747023566

Part number

CHPT 10.4



Catalogue drawings

CHP CAP - MHP MAP

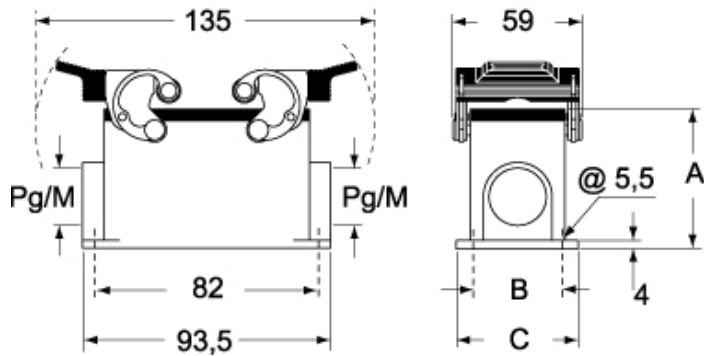

CHP CS/CP CAP CS/CP - MHP CS/CP MAP CS/CP

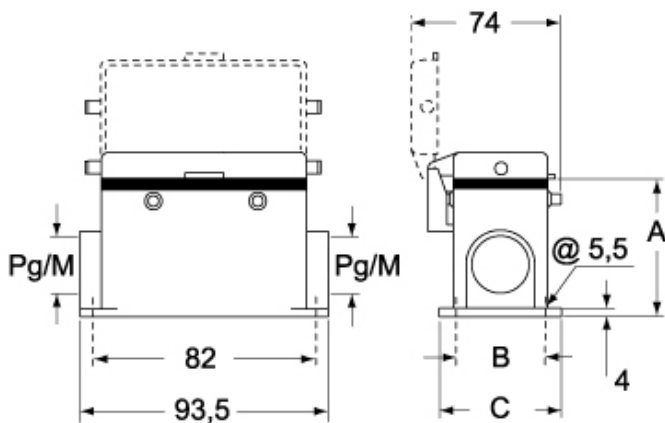

	A	B	C
CHP L / MHP L	57	40	52
CAP L / MAP L	73	45	57
CHP CS / MHP CS	57	40	52
CAP CS / MAP CS	73	45	57
CHP CP / MHP CP	57	40	52
CAP CP / MAP CP	73	45	57